

---

# Arpan

In front view this design seems to be a plain rectangular handle. Looking at it more closely though, the form turns out to be more complex. A discrete vertical opening stretches along its entire length, connecting two opposite shapes. The 'Arpan' handle was imagined for the music room of a jazz and modernist lover.





---

## Door handle

### Lever handle on rose left or right

BEQU-ARPAN  
ROSA-ARPAN

handle  
D: 69 mm  
L: 132mm  
rose:  
45 x 45 x 8mm

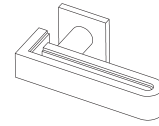

---

## Door accessories

### Thumb turn on rose

BCON-ARPAN  
ROSA-ARPAN

thumb:  
D: 38 mm  
L: 25 mm  
rose:  
45 x 45 x 8 mm



### Key escutcheon

ECLE-ARPAN

D: 8 mm  
L: 45 mm  
H: 45 mm



### Cylinder escutcheon

ECYL-ARPAN

D: 8 mm  
L: 45 mm  
H: 45 mm



---

The 'Arpan' collection is made of solid brass with a polished nickel finish. Other finishes are available on demand.



## Alexandre André

Decorator, Alexandre André, has been devoted to images since his childhood in the family artist studio. He happily marries eighteenth and nineteenth century styles, modernist objects and a contemporary spirit. André likes to transcend a place by revealing its timelessness and he always starts with the house itself - it is the house that enlightens his work.



**Maison Vervloet**  
Rue de la Borne 78  
1080 Brussels  
Belgium

[info@vervloet.com](mailto:info@vervloet.com)  
[www.vervloet.com](http://www.vervloet.com)